



Price

£100,000

Leasehold

1x  1x  1x 

**Homepeak House,
Bartholomew Street,
Hythe, Kent, CT21**

Wards
Helping you move forwards



Main features

- **Refurbished first floor retirement apartment with direct access to the communal gardens**
- **Re-fitted kitchen and shower room with large walk-in shower**
- **No onward chain**
- **For the over 60s only**
- **Communal lounge and laundry, guest suite available**

Accommodation

FIRST FLOOR

Entrance Hall

Lounge: 14'2 x 11'6 (4.32m x 3.51m)

Kitchen: 7'1 x 5'10 (2.16m x 1.78m)

Bedroom: 17'5 x 8'7 (5.31m x 2.62m)

Shower Room: 8'6 x 5'10 (2.59m x 1.78m)

OUTSIDE

Communal Car Park

Communal Gardens

First Floor

Approx. 44.7 sq. metres (480.6 sq. feet)

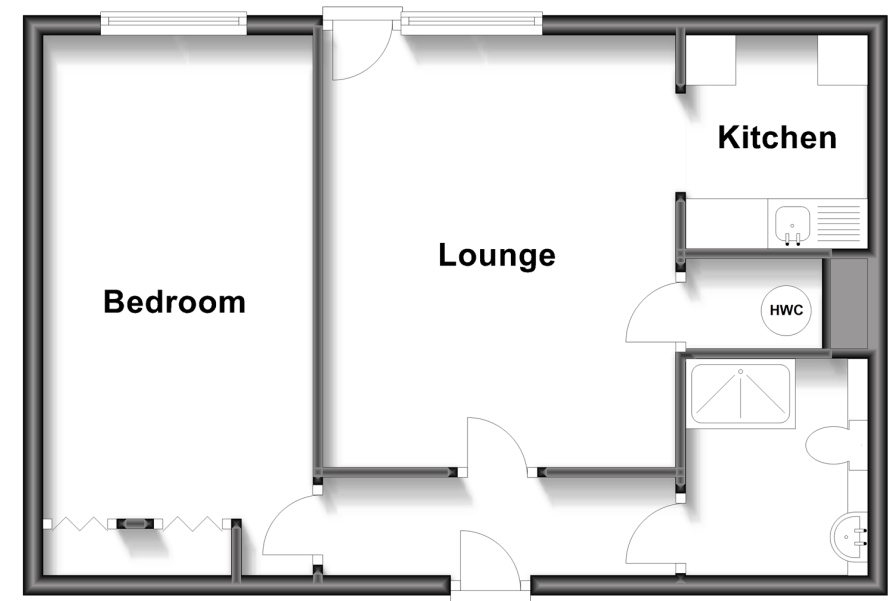

Call Hythe - 01303 267473 ■ wardsofkent.co.uk

■ Legal advice should be taken to verify fixtures/fittings, planning, alterations and/or lease details

■ Appliances & services are untested, dimensions are approximate and floor plans are not to scale