



Price

£110,000

Leasehold

1x  1x  1x 

**Prince Of Wales Park,
Burmarsh Road, Hythe,
Kent, CT21**

Wards
Helping you move forwards



Main features

- Popular quiet site for the over 55s, new boiler in 25/02/21
- All fitted furniture in the bedroom is included
- Re-fitted shower room, redecorated and new carpet in lounge
- Modern kitchen/diner with a recently replaced boiler
- No onward chain

Accommodation

GROUND FLOOR

Entrance Hall

Lounge: 12'6 x 11'6 (3.81m x 3.51m)

Kitchen/Diner: 11'5 x 9'1 (3.48m x 2.77m)

Bedroom: 9'6 x 7'8 (2.90m x 2.34m)

Shower Room: 6'8 x 5'5 (2.03m x 1.65m)

OUTSIDE

Front, Side & Rear Garden

Ground Floor

Approx. 39.5 sq. metres (425.4 sq. feet)

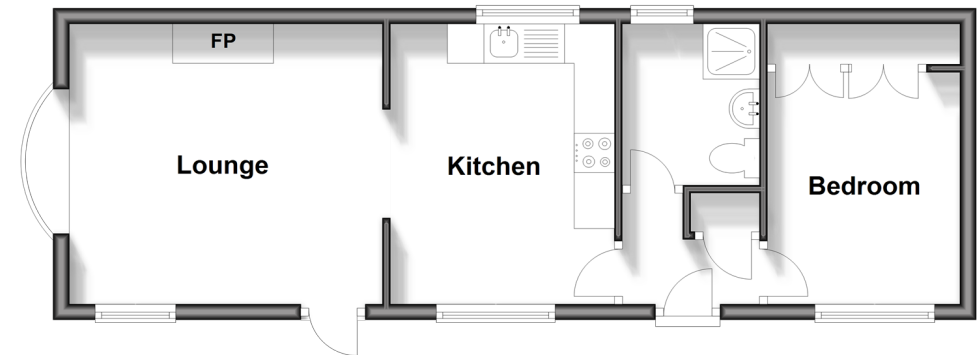

Call Hythe - 01303 267473 ■ wardsofkent.co.uk

- If buying to let, the energy rating will need to be improved to at least 'E' rating before you can let the property
- Appliances & services are untested, dimensions are approximate and floor plans are not to scale

- Legal advice should be taken to verify fixtures/fittings, planning, alterations and/or lease details



12824628/20240112/MARK/MB