



Price
£225,000

**Share of
Freehold**

1x  1x  1x 

**The Maltings, High
Street, Hythe, Kent,
CT21**

OVER 60?

Secure this property
for up to **59% less!**

Wards
Helping you move forwards



Main features

- Beautiful apartment located on Hythe High Street
- No onward chain
- Lovely kitchen, good size shower room
- Bedroom with walk-in wardrobe
- Lift to all floors, allocated parking
- Easy access to a fantastic selection of shop, restaurants and cafes

Accommodation

FIRST FLOOR

Entrance Hall

Lounge/Diner: 15'5 x 12'3 (4.70m x 3.74m)

Kitchen: 12'0 x 6'3 (3.66m x 1.91m)

Shower Room: 8'2 x 5'6 (2.49m x 1.68m)

Bedroom: 13'5 x 10'9 (4.09m x 3.28m)

Walk-In Wardrobe

OUTSIDE

Allocated Parking

First Floor

Approx. 51.9 sq. metres (558.3 sq. feet)

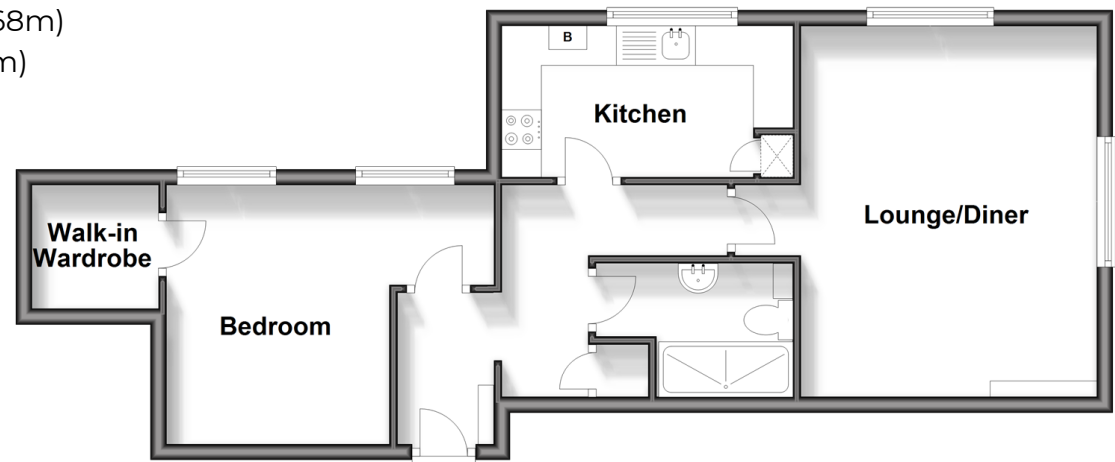

Call Hythe - 01303 267473 ■ wardsof Kent.co.uk

■ Legal advice should be taken to verify fixtures/fittings, planning, alterations and/or lease details
 ■ Through a Homewise Home For Life Plan people aged 60+ can secure this property for up to 59% less, by purchasing a Lifetime Lease.

■ Appliances & services are untested, dimensions are approximate and floor plans are not to scale