



Price
£50,000

3x  1x  1x 

**Hythe Road, Dymchurch,
Romney Marsh, Kent,
TN29**

Wards
Helping you move forwards



Main features

- **Furnished holiday home sited in 2023**
- **Atlas Sahara 39"x12" in immaculate condition with no chain**
- **Balcony to relax on**
- **Sleeps up to 8 people**
- **Swimming pool and shop on site**
- **Just over the road from the beach**
- **Must vacate the site for 2 weeks on 14th February each year**

Accommodation

GROUND FLOOR

Lounge/Kitchen/Diner: 19'2 x 11'7 (5.85m x 3.53m)
 Balcony
 Hallway
 Bedroom 1: 11'1 x 6'5 (3.38m x 1.96m)
 Bedroom 2: 8'4 x 5'8 (2.54m x 1.73m)
 Bedroom 3: 7'9 x 5'1 (2.36m x 1.55m)
 Shower Room: 6'5 x 3'3 (1.96m x 0.99m)
 Cloakroom

OUTSIDE

Wrap Around Garden
 Communal Car Park

Ground Floor

Approx. 43.2 sq. metres (464.6 sq. feet)

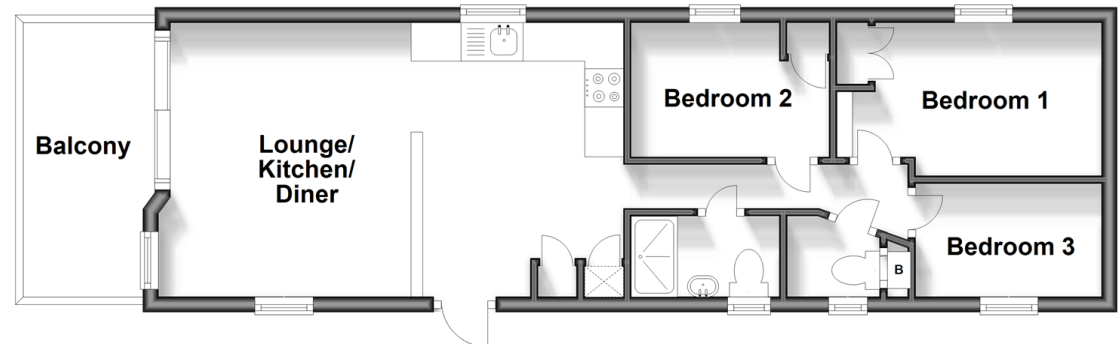

Call Hythe - 01303 267473 ■ wardsofKent.co.uk

- The seller is a person connected with Wards as defined in the Estate Agents Act 1979
- Legal advice should be taken to verify fixtures/fittings, planning, alterations and/or lease details

- If buying to let, the energy rating will need to be improved to at least 'E' rating before you can let the property
- Appliances & services are untested, dimensions are approximate and floor plans are not to scale



12824702/20240501/DC/MB