



**Price**  
**£375,000**

**Freehold**

3x  1x  2x 

**Primrose Drive, Ditton,  
Aylesford, Kent, ME20**

**OVER 60?**

Secure this property  
for up to **59% less!**

*Wards*  
Helping you move forwards



## Main features

- Hugely extended & no forward chain
- Bi-folding doors complement the stunning kitchen/dining area
- Wonderful rear garden - enjoy the outdoors without leaving home
- Ground floor cloakroom adds extra convenience
- Useful utility room frees up space & clutter from the kitchen

## Accommodation

### GROUND FLOOR

Entrance Porch

Lounge: 14'6" x 13'3" (4.42m x 4.04m)

Kitchen: 14'8" x 9'10" (4.47m x 3.00m)

Dining Area: 14'8" x 7'3" (4.47m x 2.21m)

Utility Room (Former Garage): 8'5" x 7'3" (2.57m x 2.21m)

Cloakroom

### FIRST FLOOR

Landing

Bedroom 1: 14'5" x 8'5" (4.40m x 2.57m)

Bedroom 2: 9'5" x 8'5" (2.87m x 2.57m)

Bedroom 3: 10'2" x 6'0" (3.10m x 1.83m)

Bathroom

### OUTSIDE

Driveway & Garage

Rear Garden

### Ground Floor

Approx. 62.5 sq. metres (672.7 sq. feet)

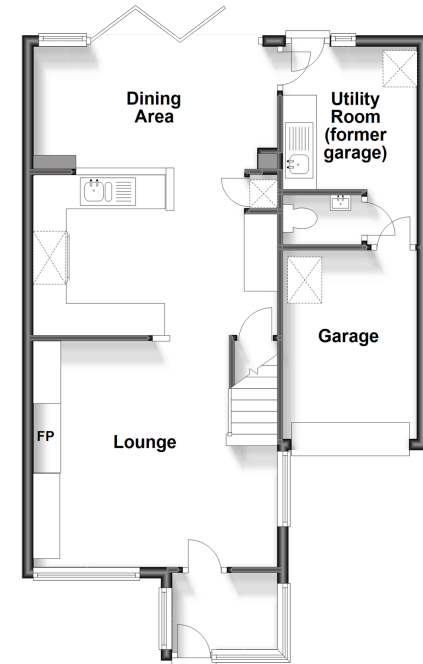

### First Floor

Approx. 33.4 sq. metres (360.0 sq. feet)

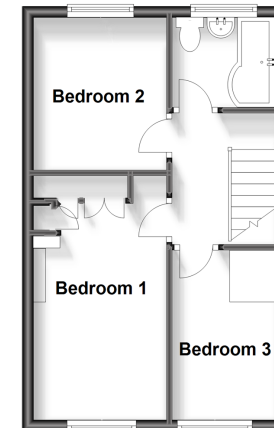

**Call Larkfield - 01732 847877 ■ [wardsof Kent.co.uk](http://wardsof Kent.co.uk)**

- Legal advice should be taken to verify fixtures/fittings, planning, alterations and/or lease details
- Appliances & services are untested, dimensions are approximate and floor plans are not to scale
- Through a Homewise Home For Life Plan people aged 60+ can secure this property for up to 59% less, by purchasing a Lifetime Lease.



12934730/20231011/HJ20/RT