

OVER 60?

Secure this property
for up to **59% less!**



Price
£350,000
Freehold

2x  1x  1x 

Rochester Road, Burham, Rochester, Kent,
ME1

Wards
Helping you move forwards



Main features

- No forward chain to worry about
- Modern kitchen with integrated appliances making cooking a pleasure
- Move in ready
- Lovely village setting - enjoy countryside walks from your door
- Great position for access to both the M2 & M20

Accommodation

GROUND FLOOR

Porch
Entrance Hall
Lounge/Diner: 14'0 x 12'10 (4.27m x 3.91m)
Kitchen: 15'7 x 10'9 (4.75m x 3.28m)
Bedroom 1: 13'5 x 9'5 (4.09m x 2.87m)
Bedroom 2: 10'6 x 9'10 (3.20m x 3.00m)
Bathroom

OUTSIDE

Front, Side & Rear Gardens

Ground Floor

Approx. 726.1 sq. feet

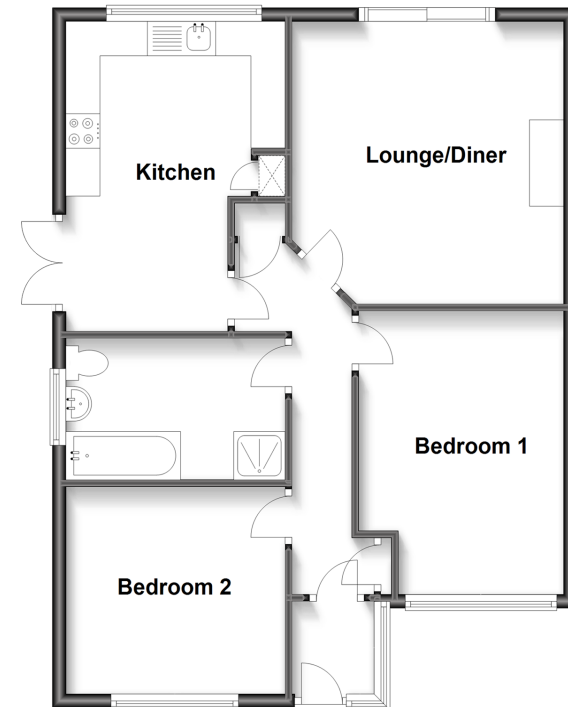

Call Larkfield - 01732 847877 ■ wardsofkent.co.uk

■ Legal advice should be taken to verify fixtures/fittings, planning, alterations and/or lease details
■ Through a Homewise Home For Life Plan people aged 60+ can secure this property for up to 59% less, by purchasing a Lifetime Lease.

■ Appliances & services are untested, dimensions are approximate and floor plans are not to scale



12934818/20230510/CK/JT