



Guide Price
£400,000

Freehold

3x  1x  1x 

**Cedar Close, Ditton,
Aylesford, Kent, ME20**

OVER 60?

Secure this property
for up to **59% less!**

Wards
Helping you move forwards



Main features

- If you're looking for a home with potential then this is a must see
- No forward chain to worry about
- All bedrooms are a good size - no box room here
- Large & private garden - a blank canvas for the new owner
- Good schools, local shops & country walks all close by

Accommodation

GROUND FLOOR

Entrance Hall

Lounge: 13'1 x 10'10 (3.99m x 3.30m)

Dining Area: 10'6 x 9'1 (3.20m x 2.77m)

Kitchen: 10'7 x 8'2 (3.23m x 2.49m)

FIRST FLOOR

Landing

Bedroom 1: 13'4 x 10'0 (4.07m x 3.05m)

Bedroom 2: 10'9 x 10'1 (3.28m x 3.08m)

Bedroom 3: 9'10 x 7'2 (3.00m x 2.19m)

Shower Room

Separate Toilet

OUTSIDE

Driveway & Garage

Front & Rear Gardens

Ground Floor
Approx. 55.0 sq. metres (592.1 sq. feet)

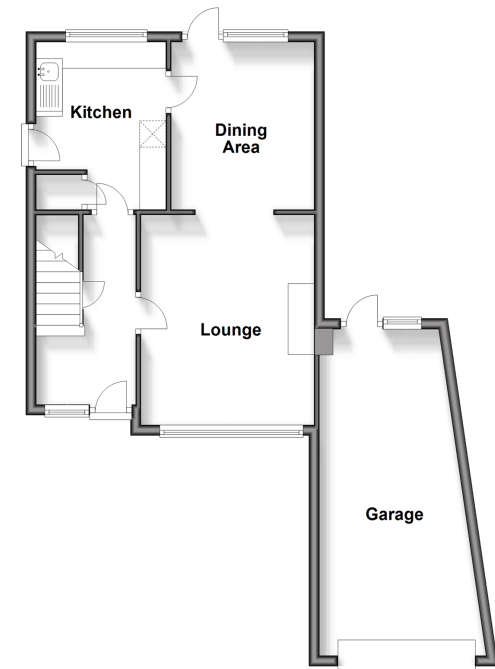

First Floor
Approx. 38.6 sq. metres (415.9 sq. feet)

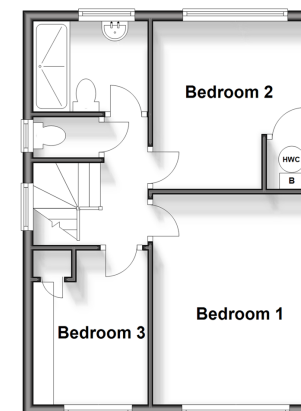

Call Larkfield - 01732 847877 ■ wardsofkent.co.uk

- Legal advice should be taken to verify fixtures/fittings, planning, alterations and/or lease details
- Appliances & services are untested, dimensions are approximate and floor plans are not to scale
- Through a Homewise Home For Life Plan people aged 60+ can secure this property for up to 59% less, by purchasing a Lifetime Lease.



12934950/20240416/CK/RT