



OVER 60?

Secure this property
for up to **59% less!**

Price

£300,000

Freehold

2x  1x  1x 

**Willowmead,
Leybourne, Kent, ME19**

Wards
Helping you move forwards



Main features

- Relax in the bright & airy lounge & enjoy the view of the lovely garden
- Allocated parking for your convenience
- Set in a quiet Close
- Great location to live - good schools & amenities within easy reach
- Excellent commuter links by road & rail close by

Accommodation

GROUND FLOOR

Entrance Porch

Kitchen: 11'9 x 8'6 (3.58m x 2.59m)

Lounge: 16'9 x 11'9 (5.11m x 3.58m)

FIRST FLOOR

Landing

Bedroom 1: 11'9 x 11'8 (3.58m x 3.56m)

Bedroom 2: 11'5 x 6'6 (3.48m x 1.98m)

Bathroom

OUTSIDE

Front & Rear Gardens

Allocated Parking

Ground Floor

Approx. 29.3 sq. metres (315.4 sq. feet)

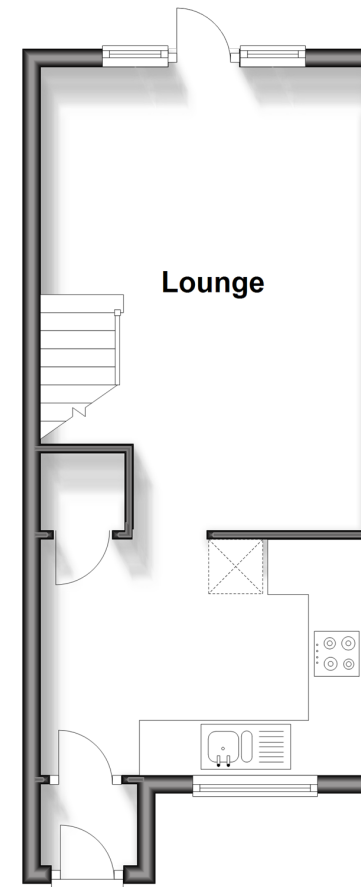

First Floor

Approx. 28.3 sq. metres (304.8 sq. feet)

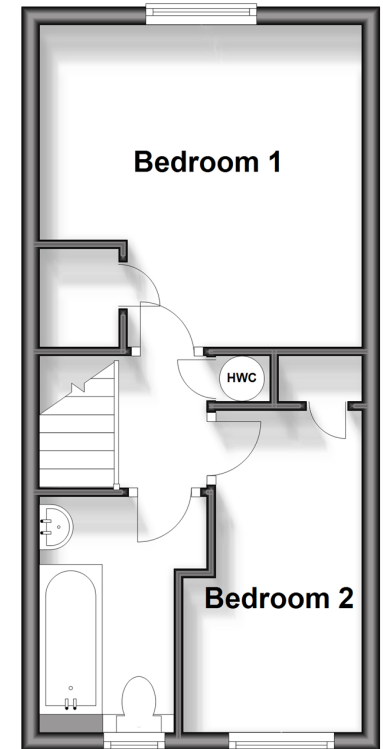

Call Larkfield - 01732 847877 ■ wardsof Kent.co.uk

- Legal advice should be taken to verify fixtures/fittings, planning, alterations and/or lease details
- Appliances & services are untested, dimensions are approximate and floor plans are not to scale
- Through a Homewise Home For Life Plan people aged 60+ can secure this property for up to 59% less, by purchasing a Lifetime Lease.



12935008/20240318/CK/JT