



Price
£200,000

Freehold

1x  1x  1x 

**Amshurst Villas, Gallants
Lane, East Farleigh,
Maidstone, Kent, ME15**

OVER 60?

Secure this property
for up to **59% less!**

Wards
Helping you move forwards



Main features

- **Parking in a communal car park**
- **Good size, yet manageable garden, perfect for relaxing in the summer**
- **Quiet, semi rural location with countryside on your doorstep, yet with nearby amenities**
- **Ideal retirement property**
- **NO FORWARD CHAIN**

Accommodation

GROUND FLOOR

Entrance Hall

Kitchen: 10'9 x 8'2 (3.28m x 2.49m)

Lounge/Diner: 17'9 x 10'9 (5.41m x 3.28m)

Bedroom : 13'8 x 8'4 (4.17m x 2.54m)

Bathroom: 8'1 x 4'5 (2.47m x 1.35m)

OUTSIDE

Communal Car Park

Front and Rear Gardens

Summer House

Ground Floor

Approx. 47.9 sq. metres (515.3 sq. feet)

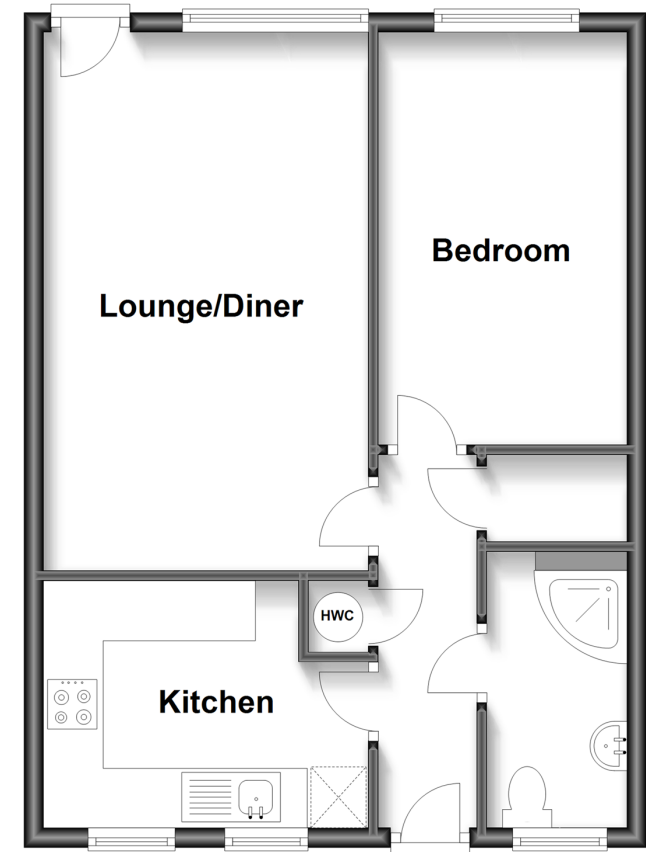

Call Loose - 01622 744067 ■ wardsofkent.co.uk

- If buying to let, the energy rating will need to be improved to at least 'E' rating before you can let the property
- Legal advice should be taken to verify fixtures/fittings, planning, alterations and/or lease details
- Appliances & services are untested, dimensions are approximate and floor plans are not to scale
- Through a Homewise Home For Life Plan people aged 60+ can secure this property for up to 59% less, by purchasing a Lifetime Lease.

EPC RATING 	CURRENT: F(34)	POTENTIAL: A(97)
<small>13021686/20230724/AS/VMK</small>		