



OVER 60?

Secure this property
for up to **59% less!**

Price

£280,000

Freehold

2x  1x  1x 

Loose Road, Maidstone, Kent, ME15

Wards
Helping you move forwards



Main features

- **Well presented home with character features and generous room sizes**
- **Useful cellar, ideal for storage, or as additional living space**
- **Modern kitchen, ideal for perfecting your culinary skills**
- **Well kept, private and low maintenance garden, with summer house with electrics currently use as a home office**
- **Popular location, short walk to Loose Primary School, local shops and amenities**

Accommodation

GROUND FLOOR

Entrance Porch
Lounge: 12'4 x 11'4 (3.76m x 3.46m)
Kitchen: 9'5 x 8'6 (2.87m x 2.59m)
Rear Lobby
Bathroom: 8'6 x 3'8 (2.59m x 1.12m)

BASEMENT

Cellar: 11'0 x 10'0 (3.36m x 3.05m)

FIRST FLOOR

Landing
Bedroom 1: 12'5 x 11'7 (3.79m x 3.53m)
Bedroom 2: 9'7 x 8'8 (2.92m x 2.64m)

OUTSIDE

Front and Rear Gardens
Summer House: 12'1 x 8'4 (3.69m x 2.54m)

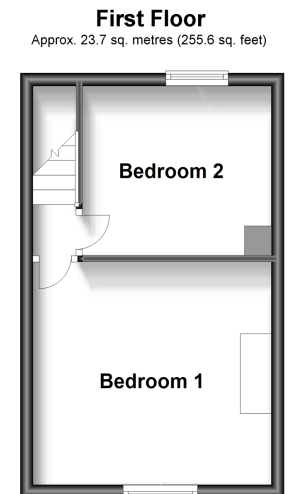
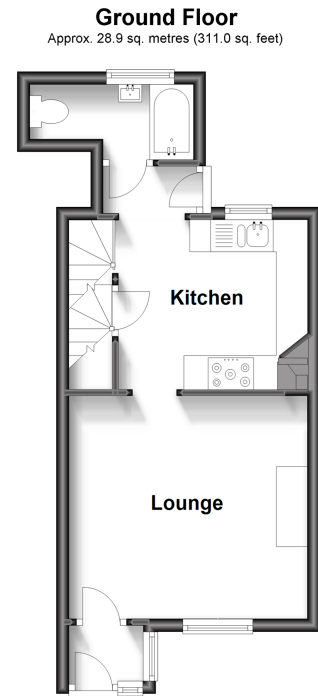
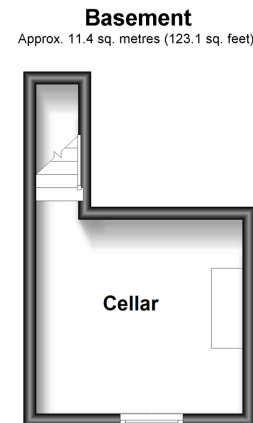

Call Loose - 01622 744067 ■ wardsofkent.co.uk

■ Legal advice should be taken to verify fixtures/fittings, planning, alterations and/or lease details
■ Through a Homewise Home For Life Plan people aged 60+ can secure this property for up to 59% less, by purchasing a Lifetime Lease.

■ Appliances & services are untested, dimensions are approximate and floor plans are not to scale

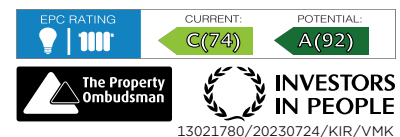

13021780/20230724/KIR/VMK