

**OVER 60?**

Secure this property  
for up to **59% less!**



**Guide Price**

**£640,000**

**Freehold**

4x  2x  1x 

Vanity Lane, Linton, Maidstone, Kent, ME17

*Wards*  
Helping you move forwards





## Main features

- Immaculately presented home finished to a high standard
- Secure garden with a fantastic entertaining space
- Versatile layout with a ground floor study/bedroom 4
- Spacious open plan kitchen/diner and family area, recently refitted, offering a superb sociable space with the 'wow factor'
- Located on a sought after semi rural road, walking distance to the village centre, with it's array of local shops and amenities, with picturesque countryside on your doorstep

## Accommodation

### GROUND FLOOR

Entrance Hall  
Lounge: 17'1 x 12'0 (5.21m x 3.66m)  
Study/Bedroom 4: 11'1 x 10'0 (3.38m x 3.05m)  
Kitchen/Diner: 29'0 x 12'1 (8.85m x 3.69m)  
Family Area: 11'0 x 9'1 (3.36m x 2.77m)  
Utility Room: 12'1 x 7'1 (3.69m x 2.16m)  
Downstairs Cloakroom

### FIRST FLOOR

Landing  
Bedroom 1: 24'1 x 19'0 (7.35m x 5.80m)  
Balcony  
En Suite Bathroom: 9'0 x 8'1 (2.75m x 2.47m)  
Bedroom 2: 12'1 x 11'0 (3.69m x 3.36m)  
Bedroom 3: 9'0 x 9'0 (2.75m x 2.75m)  
Bathroom: 8'1 x 7'1 (2.47m x 2.16m)  
Storage  
Eaves

### OUTSIDE

Garage and Driveway  
Front and Rear Gardens  
Greenhouse

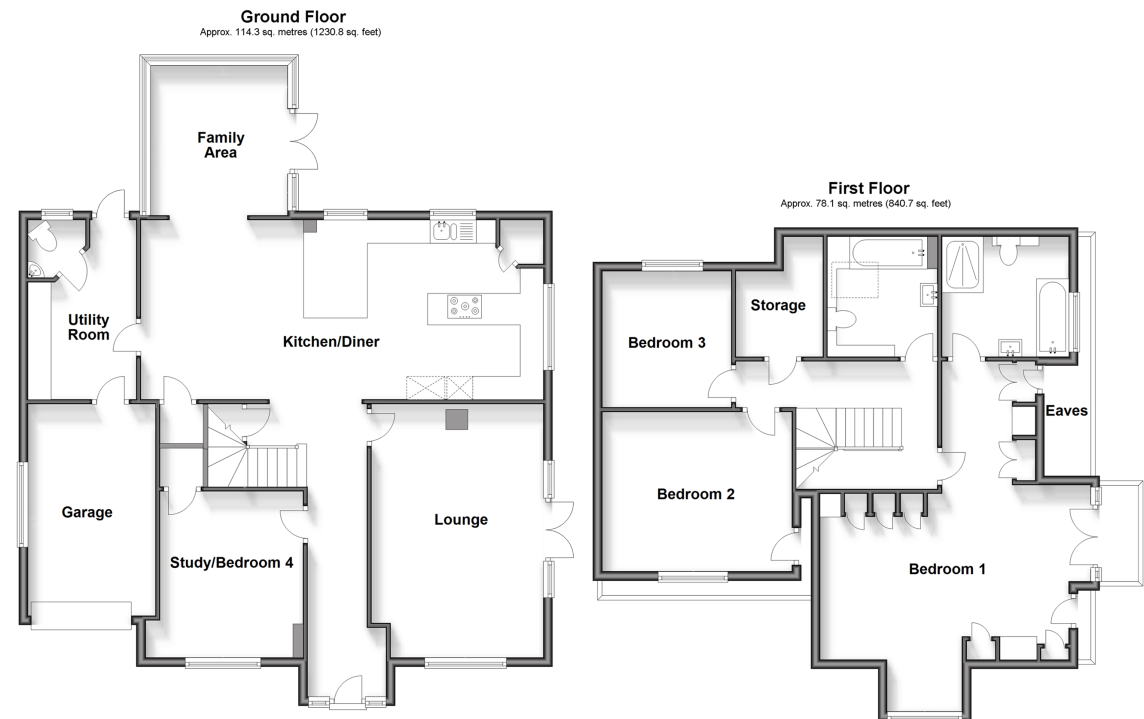

**Call Loose - 01622 744067 ■ [wardsofkent.co.uk](http://wardsofkent.co.uk)**

■ Legal advice should be taken to verify fixtures/fittings, planning, alterations and/or lease details  
■ Through a Homewise Home For Life Plan people aged 60+ can secure this property for up to 59% less, by purchasing a Lifetime Lease.

■ Appliances & services are untested, dimensions are approximate and floor plans are not to scale



13021885/20240212/KIR/VMK