



Price
£335,000

Freehold

2x  1x  1x 

**Downs View Road,
Penenden Heath,
Maidstone, Kent ME14**

OVER 60?

Secure this property
for up to **59% less!**

Wards
Helping you move forwards



Main features

- Very popular Penenden Heath location
- Generous size plot, lovely garden with artificial lawn and multiple outbuildings
- Contemporary bathroom and kitchen
- Off road parking
- Ideal location for local shops, schools, access to the motorways and walking opportunities

Accommodation

GROUND FLOOR

Hallway

Lounge: 13'1 x 10'10 (3.99m x 3.30m)

Kitchen: 10'6 x 9'1 (3.20m x 2.77m)

Bedroom 1: 12'0 x 10'0 (3.66m x 3.05m)

Bedroom 2: 9'5 x 8'5 (2.87m x 2.57m)

Bathroom: 6'5 x 5'7 (1.96m x 1.70m)

OUTSIDE

Rear Garden

Front Garden

Driveway

Ground Floor

Approx. 53.7 sq. metres (577.8 sq. feet)

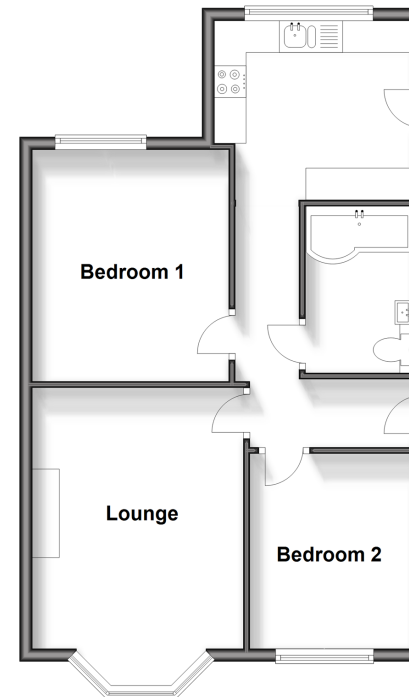

Call Maidstone - 01622 683737 ■ wardsofkent.co.uk

■ Legal advice should be taken to verify fixtures/fittings, planning, alterations and/or lease details
 ■ Through a Homewise Home For Life Plan people aged 60+ can secure this property for up to 59% less, by purchasing a Lifetime Lease.

■ Appliances & services are untested, dimensions are approximate and floor plans are not to scale