



**OVER 60?**

Secure this property  
for up to **59% less!**

**Guide Price**  
**£400,000**

**Freehold**

4x  2x  2x 

**College Road,  
Maidstone, Kent ME15  
6SJ**

*Wards*  
Helping you move forwards

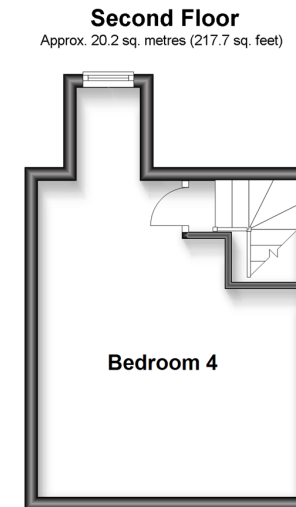
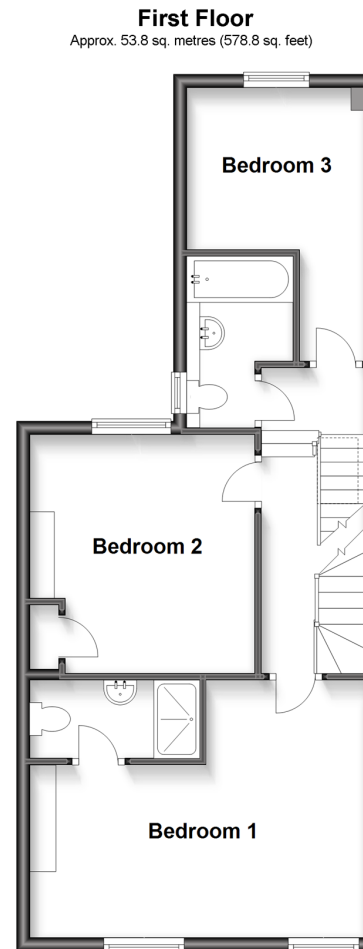

## Accommodation

### GROUND FLOOR

Hallway  
Lounge: 13'2 x 12'8 (4.02m x 3.86m)  
Dining Room: 11'9 x 11'2 (3.58m x 3.41m)  
Kitchen: 13'7 x 8'9 (4.14m x 2.67m)

### BASEMENT

Cellar: 16'5 x 12'5 (5.01m x 3.79m)

### FIRST FLOOR

Landing  
Bedroom 1: 16'0 x 12'0 (4.88m x 3.66m)  
En-Suite Shower Room  
Bedroom 2: 11'0 x 11'0 (3.36m x 3.36m)  
Bedroom 3: 12'0 x 9'0 (3.66m x 2.75m)  
Bathroom

### SECOND FLOOR

Landing  
Bedroom 4: 20'0 x 12'0 (6.10m x 3.66m)

### OUTSIDE

Rear Garden  
Front Garden  
Driveway To Rear





## Main features

- Substantial chain free period house
- Generous accommodation arranged over 4 floors
- Refitted kitchen and bathroom together with a full cosmetic overhaul
- Within close proximity to the town centre
- Ample off road parking to rear for numerous vehicles



### Nearest Schools

Primary Schools: Archbishop Courtenay Primary 0.1 miles, Maidstone, St Michael's C of E Junior School 1.0 miles, South Borough Primary 1.0 miles

Secondary Schools: Maidstone Grammar 0.9 miles



### Transport Information

Train Stations: Maidstone West 0.7 miles, Maidstone Barracks 1.0 miles, Maidstone East 1.1 miles



### Address

College Road, Maidstone, Kent ME15 6SJ



### Directions

For directions to this property please contact us.



Call Maidstone Branch 01622 683737 ■ [wardsofkent.co.uk](https://wardsofkent.co.uk)



■ If buying to let, the energy rating will need to be improved to at least 'E' rating before you can let the property  
■ Appliances & services are untested, dimensions are approximate and floor plans are not to scale

■ Legal advice should be taken to verify fixtures/fittings, planning, alterations and/or lease details  
■ Through a Homewise Home For Life Plan people aged 60+ can secure this property for up to 59% less, by purchasing a Lifetime Lease.

13156759/20240415/TMW/DS