



**OVER 60?**

Secure this property  
for up to **59% less!**

**Price**

**£280,000**

**Freehold**

2x  1x  2x 

**Waterlow Road,  
Maidstone, Kent, ME14**

*Wards*  
Helping you move forwards





## Main features

- Immaculately presented 3 storey Victorian character property
- No forward chain
- Double chamber basement used as studio
- High quality kitchen and bathroom
- Very convenient location with access to the station, town centre and a wide range of amenities

## Accommodation

### GROUND FLOOR

Lounge: 12'0 x 10'10 (3.66m x 3.30m)

Kitchen: 12'0 x 10'1 (3.66m x 3.08m)

Rear Lobby

Bathroom: 8'5 x 6'1 (2.57m x 1.86m)

### LOWER GROUND FLOOR

Basement Room 1: 10'5 x 9'6 (3.18m x 2.90m)

Basement Room 2: 11'7 x 9'6 (3.53m x 2.90m)

### FIRST FLOOR

Landing

Bedroom 1: 11'9 x 10'1 (3.58m x 3.08m)

Bedroom 2: 12'0 x 10'2 (3.66m x 3.10m)

### OUTSIDE

Rear Garden

**Ground Floor**  
Approx. 33.9 sq. metres (364.9 sq. feet)



**Basement**  
Approx. 24.1 sq. metres (259.9 sq. feet)

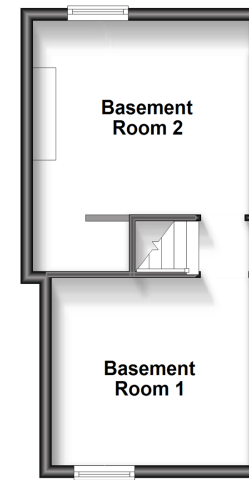

**First Floor**  
Approx. 26.6 sq. metres (286.5 sq. feet)

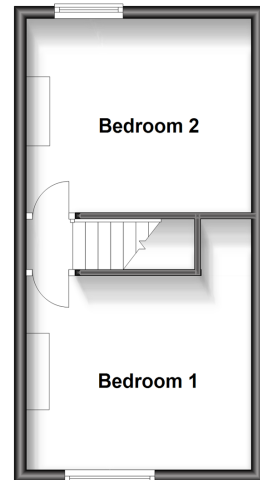

**Call Maidstone - 01622 683737 ■ [wardsofkent.co.uk](http://wardsofkent.co.uk)**

- Legal advice should be taken to verify fixtures/fittings, planning, alterations and/or lease details
- Appliances & services are untested, dimensions are approximate and floor plans are not to scale
- Through a Homewise Home For Life Plan people aged 60+ can secure this property for up to 59% less, by purchasing a Lifetime Lease.



13157637/20230603/CV/MB