



Price
£250,000

Freehold

2x  1x  1x 

**Old Cottages, Tovil
Green, Maidstone, Kent
ME15**

OVER 60?

Secure this property
for up to **59% less!**

Wards
Helping you move forwards

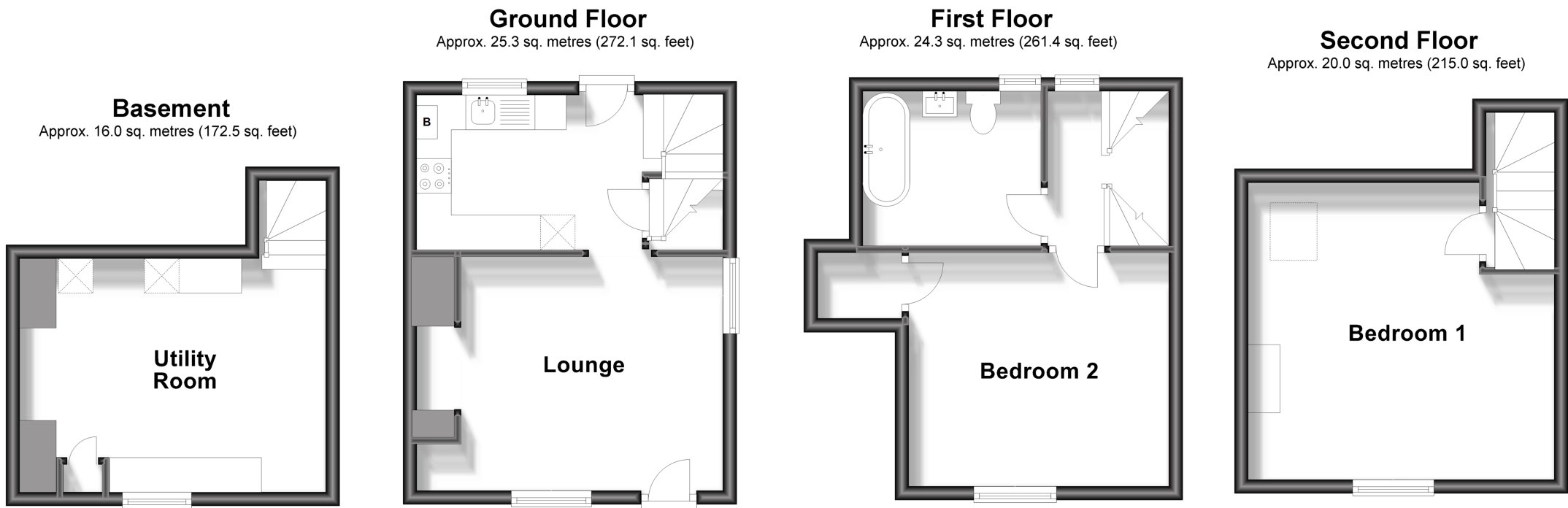

Accommodation

GROUND FLOOR

Lounge: 12'3 x 11'0 (3.74m x 3.36m)

Kitchen: 10'6 x 7'3 (3.20m x 2.21m)

BASEMENT

Utility Room: 11'4 x 10'5 (3.46m x 3.18m)

FIRST FLOOR

Landing

Bedroom 2: 12'4 x 11'0 (3.76m x 3.36m)

Bathroom

SECOND FLOOR

Landing

Bedroom 1: 14'3 x 13'8 (4.35m x 4.17m)

OUTSIDE

Courtyard Rear Garden

Front Garden



Main features

- Charming Grade II listed weatherboard clad cottage
- Accommodation arranged over 4 floors with modern kitchen and basement utility room
- Victorian style 1st floor bathroom
- Feature inset wood burner, central heating and double glazing
- Chain free



Nearest Schools

Primary Schools: Maidstone, St Michael's C of E Junior School 0.3 miles, Archbishop Courtenay Primary 0.7 miles, South Borough Primary 0.7 miles



Transport Information

Train Stations: Maidstone West 0.5 miles, Maidstone Barracks 0.9 miles, East Farleigh 1.0 miles



Address

Old Cottages, Tovil Green, Maidstone, Kent ME15



Directions

For directions to this property please contact us.



Wards
Helping you move forwards

Call Maidstone Branch 01622 683737 ■ wardsofkent.co.uk



■ Legal advice should be taken to verify fixtures/fittings, planning, alterations and/or lease details ■ Appliances & services are untested, dimensions are approximate and floor plans are not to scale
■ Through a Homewise Home For Life Plan people aged 60+ can secure this property for up to 59% less, by purchasing a Lifetime Lease.



13157815/20231026/MB/DS