



Guide Price
£300,000

Freehold

3x  1x  1x 

**Longfield Place,
Maidstone, Kent ME15**

OVER 60?

Secure this property
for up to **59% less!**

Wards
Helping you move forwards



Main features

- Popular South Maidstone location
- Quiet cul-de-sac set back off the road
- Secondary inner courtyard for maximum privacy
- Car port and driveway
- Deceptively spacious home with generous sized garden that is not overlooked

Accommodation

GROUND FLOOR

Hallway
 Kitchen: 10'2 x 7'1 (3.10m x 2.16m)
 Dining Area: 10'6 x 9'6 (3.20m x 2.90m)
 Lounge: 15'7 x 10'6 (4.75m x 3.20m)
 Cloakroom
 Bedroom 1: 13'4 x 10'0 (4.07m x 3.05m)
 Bedroom 2: 10'2 x 9'2 (3.10m x 2.80m)
 Bedroom 3: 10'2 x 6'11 (3.10m x 2.11m)
 Shower Room

OUTSIDE

Rear Garden
 Front Garden
 Car Port
 Driveway

Ground Floor
 Approx. 77.4 sq. metres (833.0 sq. feet)

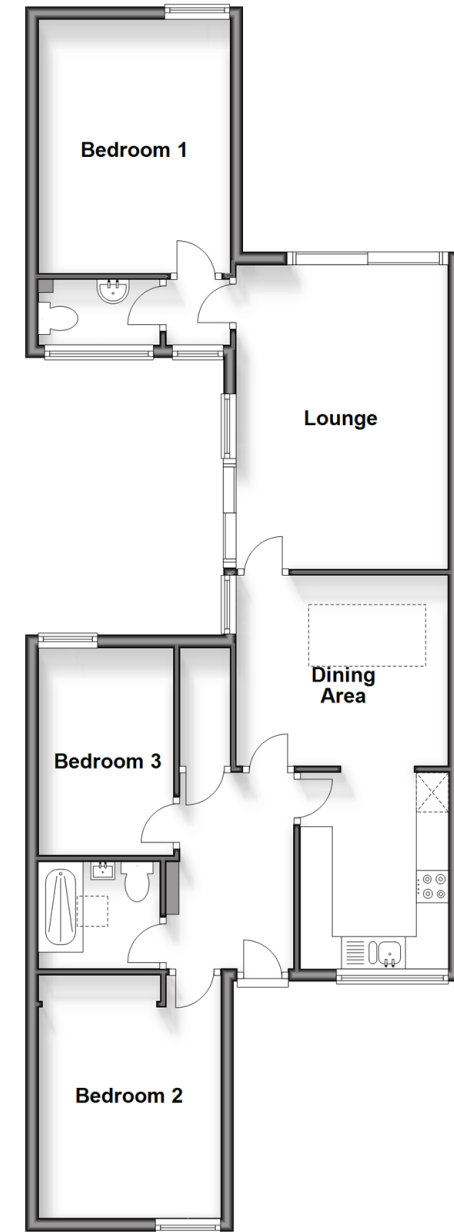

Call Maidstone - 01622 683737 ■ wardsofkent.co.uk

- Legal advice should be taken to verify fixtures/fittings, planning, alterations and/or lease details
- Appliances & services are untested, dimensions are approximate and floor plans are not to scale
- Through a Homewise Home For Life Plan people aged 60+ can secure this property for up to 59% less, by purchasing a Lifetime Lease.



13158056/20240403/SS1/LB01