



Guide Price
£475,000

Freehold

2x  1x  1x 

**Mulberry Close,
Meopham, Kent, DA13**

OVER 60?

Secure this property
for up to **59% less!**

Wards
Helping you move forwards



Main features

- Traditional single storey dwelling ideal for those looking to downsize
- Walking distance to local shops and amenities at Meopham
- Impressive rear extension offering separate dining area
- Plenty of space on driveway for parking with garage too
- Opportunity to improve internally

Accommodation

GROUND FLOOR

Hallway

Lounge: (L-shaped) 18'4 x 11'9 (5.59m x 3.58m) plus 8'10 x 3'2 (2.69m x 0.97m)

Dining Area: 11'11 x 8'2 (3.63m x 2.49m)

Kitchen: 11'3 x 9'1 (3.43m x 2.77m)

Bedroom 1: 12'6 x 11'11 (3.81m x 3.63m)

Bedroom 2: 9'5 x 8'9 (2.87m x 2.67m)

Wet Room: 8'1 x 5'7 (2.47m x 1.70m)

OUTSIDE

Garage

Driveway

Front Garden

Rear Garden

Ground Floor

Approx. 76.7 sq. metres (826.0 sq. feet)

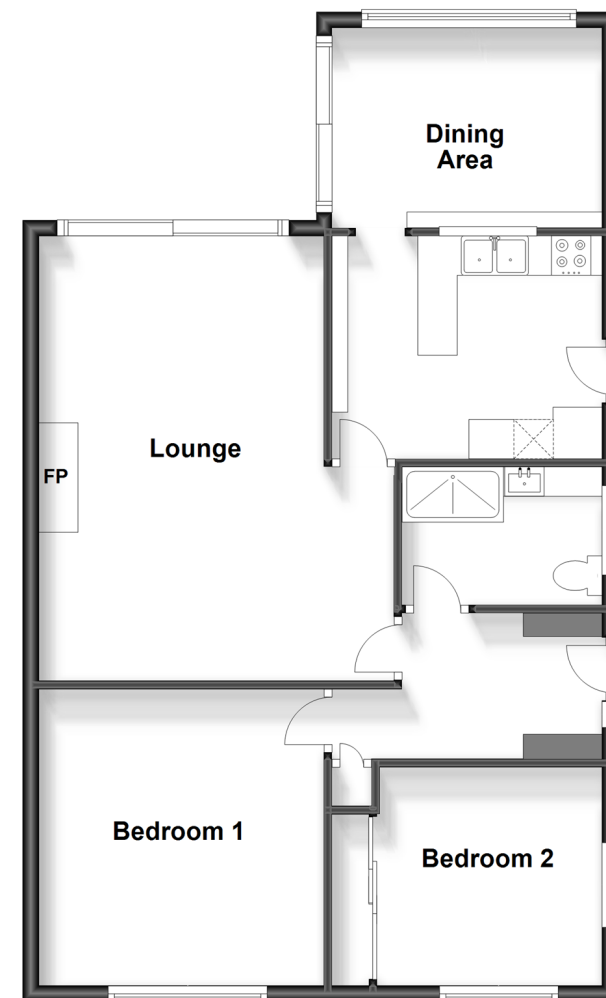

Call Meopham - 01474 813100 ■ wardsof Kent.co.uk

- Legal advice should be taken to verify fixtures/fittings, planning, alterations and/or lease details
- Appliances & services are untested, dimensions are approximate and floor plans are not to scale
- Through a Homewise Home For Life Plan people aged 60+ can secure this property for up to 59% less, by purchasing a Lifetime Lease.

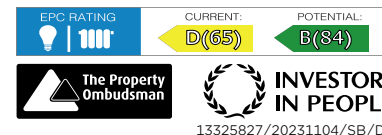

13325827/20231104/SB/DF