



Price
£425,000

Freehold

2x  1x  2x 

**Hill View Road, New
Barn, Kent, DA3**

OVER 60?

Secure this property
for up to **59% less!**

Wards
Helping you move forwards



Main features

- **Spacious and manageable rear garden**
- **Good size driveway and garage**
- **Opportunity to improve internal decoration**
- **Huge scope to further extend (subject to usual consents)**
- **Short drive to Longfield Station with access to London Victoria**

Accommodation

GROUND FLOOR

Hallway

Lounge: 15'0 x 10'10 (4.58m x 3.30m)

Kitchen: 10'11 x 8'10 (3.33m x 2.69m)

Bedroom 1: 12'1 x 10'11 (3.69m x 3.33m)

Bedroom 2: 10'11 x 8'11 (3.33m x 2.72m) plus 7'7 x 2'4 (2.31m x 0.71m)

Shower Room: 6'4 x 5'8 (1.93m x 1.73m)

Dining Room (Used as Bedroom): 15'10 x 9'7 (4.83m x 2.92m)

OUTSIDE

Driveway

Garage

Rear Garden

Ground Floor

Approx. 76.3 sq. metres (821.1 sq. feet)

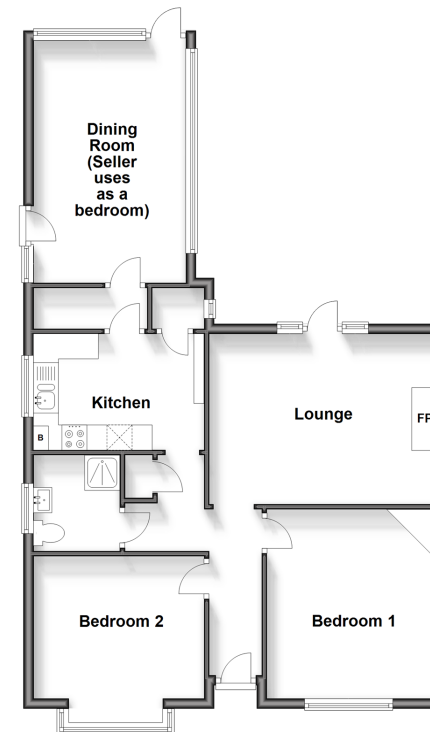

Outbuilding

Approx. 15.4 sq. metres (165.8 sq. feet)

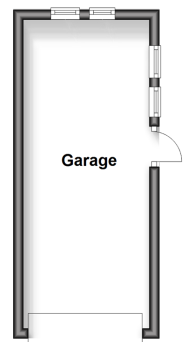

Call Meopham - 01474 813100 ■ wardsofkent.co.uk

■ Legal advice should be taken to verify fixtures/fittings, planning, alterations and/or lease details
 ■ Through a Homewise Home For Life Plan people aged 60+ can secure this property for up to 59% less, by purchasing a Lifetime Lease.

■ Appliances & services are untested, dimensions are approximate and floor plans are not to scale



13325867/20240316/SB/DF