



Price
£600,000

Freehold

4x  2x  2x 

**Downs Valley, Hartley,
Longfield, Kent, DA3**

OVER 60?

Secure this property
for up to **59% less!**

Wards
Helping you move forwards



Main features

- Desirable location just walking distance from Longfield Station
- Stunning bathroom with modern skylight and automatic rain sensor
- Spacious bedroom sizes throughout
- Manageable rear garden, with new decking, ideal for entertaining
- Close to desirable schools in Hartley

Accommodation

GROUND FLOOR

Hallway
 Cloakroom: 5'0 x 3'0 (1.53m x 0.92m)
 Lounge: 16'4 x 12'8 (4.98m x 3.86m)
 Kitchen: 18'11 x 8'7 (5.77m x 2.62m)
 Utility Room: 7'10 x 4'6 (2.39m x 1.37m)
 Dining Room: 11'7 x 10'11 (3.53m x 3.33m)

FIRST FLOOR

Landing
 Bedroom 1: 13'3 x 12'8 (4.04m x 3.86m)
 Ensuite Shower Room: 7'3 x 2'10 (2.21m x 0.86m)
 Bedroom 2: 11'6 x 10'11 (3.51m x 3.33m)
 Bedroom 3: 16'5 x 8'6 (5.01m x 2.59m)
 Bedroom 4: 11'0 x 9'8 (3.36m x 2.95m)
 Bathroom: 8'6 x 7'7 (2.59m x 2.31m)

OUTSIDE

Driveway
 Former Garage: 11'5 x 8'5 (3.48m x 2.57m)
 Front Garden
 Rear Garden

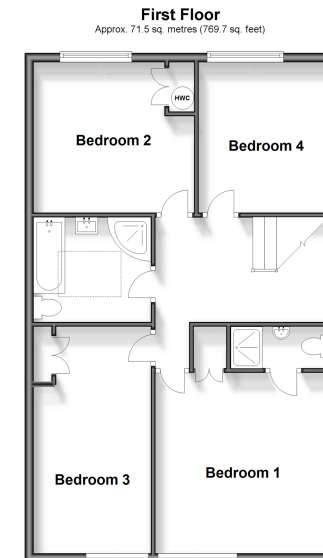
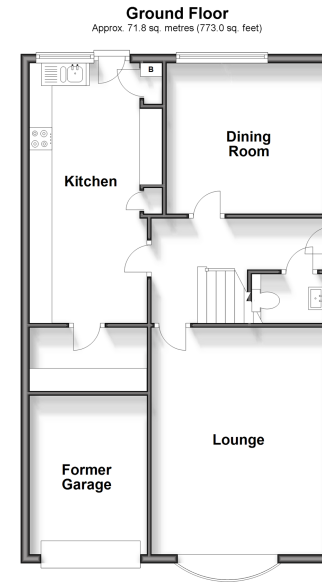

Call New Ash Green - 01474 872466 ■ wardsof Kent.co.uk

- Legal advice should be taken to verify fixtures/fittings, planning, alterations and/or lease details
- Appliances & services are untested, dimensions are approximate and floor plans are not to scale
- Through a Homewise Home For Life Plan people aged 60+ can secure this property for up to 59% less, by purchasing a Lifetime Lease.



13419034/20240410/DF/DF