



OVER 60?

Secure this property
for up to **59% less!**

Price

£275,000

Freehold

2x  1x  1x 

**Seabourne Way,
Dymchurch, Romney
Marsh, Kent, TN29**

Wards
Helping you move forwards



Main features

- Ideal home for updating
- Mature well established garden
- No onward chain so a quick sale could be available
- Walking distance to shops, amenities, cafes and takeaways
- Short walk to Dymchurch's lovely sandy beach

Accommodation

GROUND FLOOR

Entrance Hall

Lounge: 21'4 x 11'2 (6.51m x 3.41m)

Kitchen: 12'3 x 6'6 (3.74m x 1.98m)

Bedroom 1: 12'4 x 11'3 (3.76m x 3.43m)

Bedroom 2: 9'8 x 6'3 (2.95m x 1.91m)

Bathroom

OUTSIDE

Off Road Parking

Garage

Front & Rear Gardens

Ground Floor

Approx. 59.4 sq. metres (639.8 sq. feet)

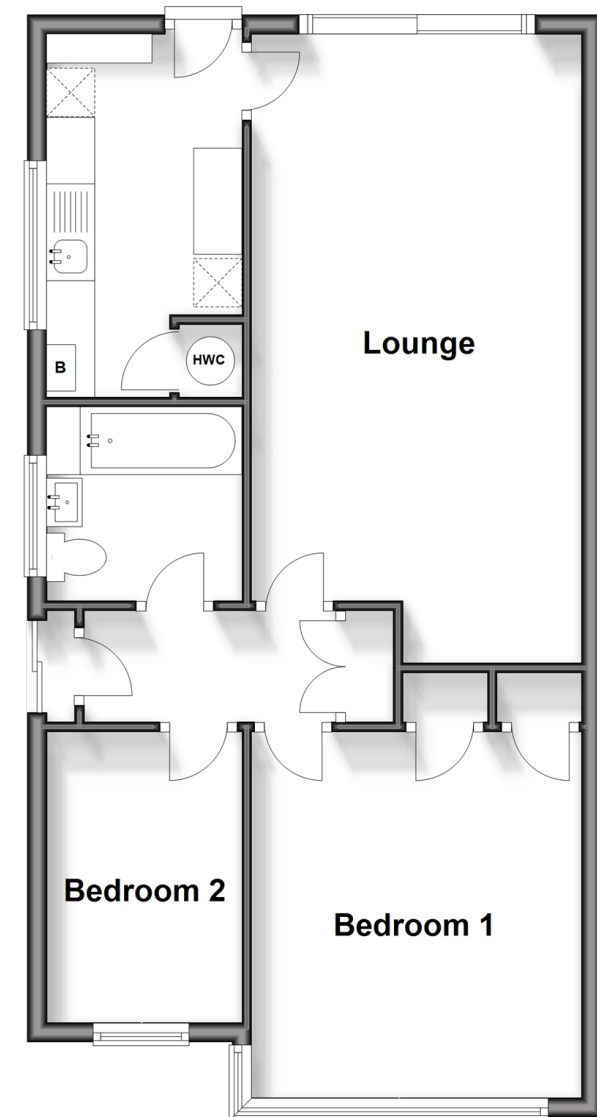

Call New Romney - 01797 363745 ■ wardsofkennt.co.uk

- Legal advice should be taken to verify fixtures/fittings, planning, alterations and/or lease details
- Appliances & services are untested, dimensions are approximate and floor plans are not to scale
- Through a Homewise Home For Life Plan people aged 60+ can secure this property for up to 59% less, by purchasing a Lifetime Lease.



13525463/20240117/AH/CA