



**Price**  
**£425,000**

**Freehold**

3x  3x  1x 

**Pine Tree Court,  
Maidstone Road,  
Paddock Wood, Kent,  
TN12**

*Wards*  
Helping you move forwards





## Main features

- Six stunning new builds with large rear gardens
- Located just a short distance from Paddock Wood station with direct links to London
- Allocated parking
- Finished to a high standard throughout
- \*STAMP DUTY PAID T&C'S APPLY\*

## Accommodation

### GROUND FLOOR

Kitchen/Diner: 15'5 x 11'1 (4.70m x 3.38m)  
Cloakroom

### FIRST FLOOR

Lounge: 15'6 x 15'2 (4.73m x 4.63m)  
Bedroom 3: 9'10 x 8'8 (3.00m x 2.64m)  
Bathroom

### SECOND FLOOR

Bedroom 1: 13'10 x 11'8 (4.22m x 3.56m)  
En Suite  
Bedroom 2: 12'1 x 9'10 (3.69m x 3.00m)

### OUTSIDE

Rear Garden  
Car Port  
Off Road Parking

**Call Paddock Wood - 01892 836877 ■ [wardsokent.co.uk](http://wardsokent.co.uk)**

- Legal advice should be taken to verify fixtures/fittings, planning, alterations and/or lease details
- Appliances & services are untested, dimensions are approximate and floor plans are not to scale

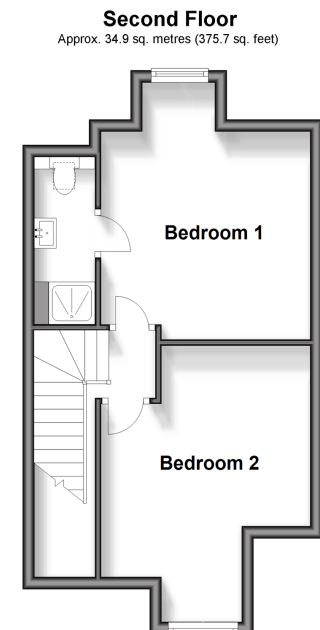
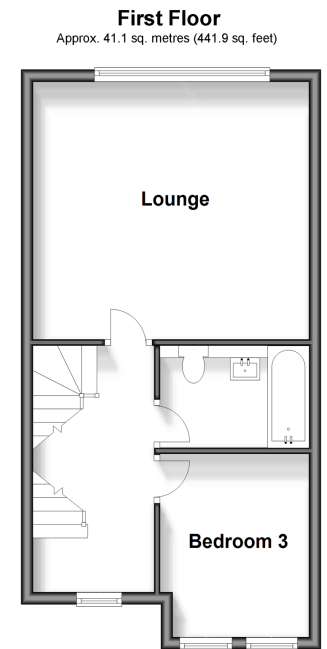
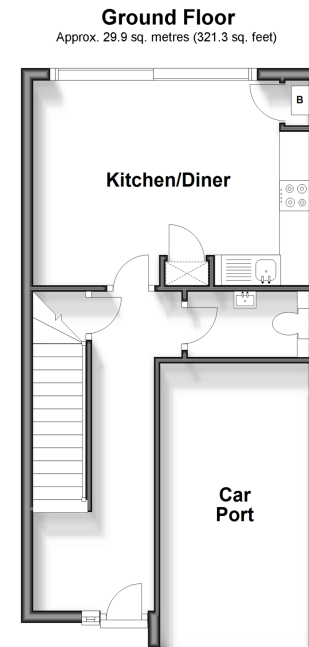

13627102/20240320/LF/GD