



Price
£425,000

Freehold

3x  3x  1x 

**Pine Tree Court,
Maidstone Road,
Paddock Wood, Kent,
TN12**

Wards
Helping you move forwards



Main features

- Six stunning new builds with large rear gardens
- Located just a short distance from Paddock Wood station with direct links to London
- Allocated parking
- Finished to a high standard throughout
- *STAMP DUTY PAID T&C'S APPLY*

Accommodation

GROUND FLOOR

Kitchen/Diner: 15'5 x 11'1 (4.70m x 3.38m)
Cloakroom

FIRST FLOOR

Lounge: 15'6 x 15'2 (4.73m x 4.63m)
Bedroom 3: 9'10 x 8'9 (3.00m x 2.67m)
Bathroom

SECOND FLOOR

Bedroom 1: 13'9 x 11'9 (4.19m x 3.58m)
En Suite
Bedroom 2: 12'1 x 9'9 (3.69m x 2.97m)

OUTSIDE

Rear Garden
Car Port
Off Road Parking

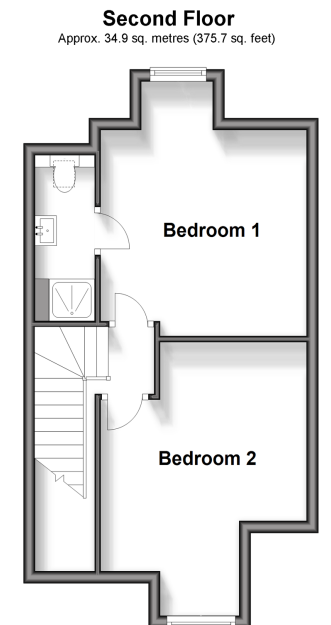
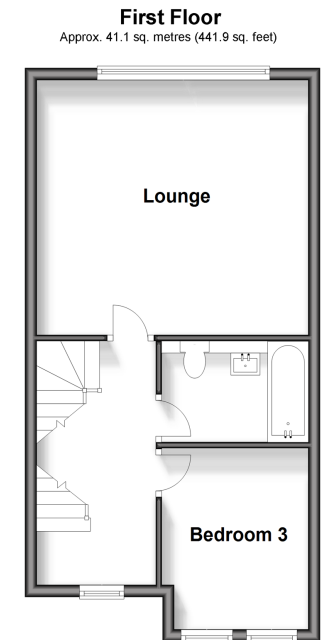
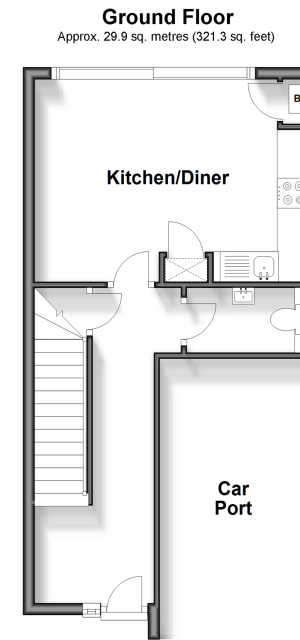

Call Paddock Wood - 01892 836877 ■ wardsokent.co.uk

- Legal advice should be taken to verify fixtures/fittings, planning, alterations and/or lease details
- Appliances & services are untested, dimensions are approximate and floor plans are not to scale



13627103/20240320/LF/GD