



Price
£250,000

Freehold

3x  1x  1x 

**High Street, Halling,
Snodland, Kent, ME2**

OVER 60?

Secure this property
for up to **59% less!**



Video Tour available

Wards
Helping you move forwards



Main features

- Beautifully refurbished home in the pretty village of Halling
- Hotel style bathroom to relax in
- Modern kitchen/dining area so entertaining is a dream here
- Handy courtyard garden to enjoy
- Lovely river walks on your doorstep, plus the convenience of excellent travel links

Accommodation

GROUND FLOOR

Lounge Area: 10'1 x 9'6 (3.08m x 2.90m)

Kitchen/Dining Area: 10'5 x 9'2 (3.18m x 2.80m)

Rear Lobby

Bathroom: 9'0 x 5'1 (2.75m x 1.55m)

FIRST FLOOR

Landing

Bedroom 1: 11'3 x 10'0 (3.43m x 3.05m)

Bedroom 2: 10'4 x 9'1 (3.15m x 2.77m)

Bedroom 3: 8'10 x 5'1 (2.69m x 1.55m)

OUTSIDE

Rear Courtyard Garden

Ground Floor

Approx. 27.3 sq. metres (293.6 sq. feet)



First Floor

Approx. 24.6 sq. metres (264.4 sq. feet)

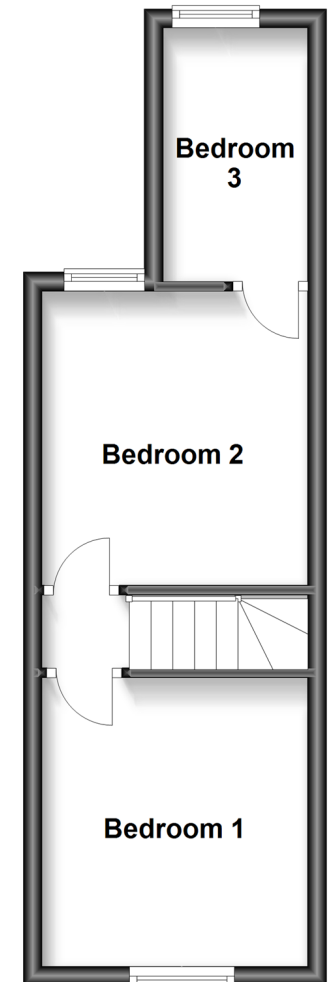

Call Snodland - 01634 245055 ■ wardsofkent.co.uk

- If buying to let, the energy rating will need to be improved to at least 'E' rating before you can let the property
- Legal advice should be taken to verify fixtures/fittings, planning, alterations and/or lease details
- Appliances & services are untested, dimensions are approximate and floor plans are not to scale
- Through a Homewise Home For Life Plan people aged 60+ can secure this property for up to 59% less, by purchasing a Lifetime Lease.

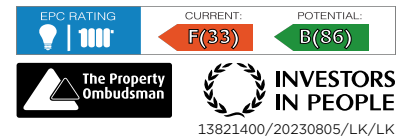

13821400/20230805/LK/LK