



Guide Price
£175,000

2x  1x  1x 

**Oak Avenue, Woodlands
Park, Biddenden,
Ashford, Kent, TN27**

Wards
Helping you move forwards



Main features

- Immaculately presented with neutral decor throughout
- Stunning open plan kitchen lounge diner
- Driveway
- En-suite to main bedroom
- Residential

Accommodation

GROUND FLOOR

Lounge/Kitchen Diner: 21'0 x 19'4 (6.41m x 5.90m)

Utility

Bedroom 1: 15'2 x 9'3 (4.63m x 2.82m)

En-suite Bathroom

Bedroom 2: 9'5 x 9'4 (2.87m x 2.85m)

En-suite Shower Room

OUTSIDE

Outbuilding: 9'9 x 9'6 (2.97m x 2.90m)

Garden

Driveway

Ground Floor

Approx. 77.8 sq. metres (836.9 sq. feet)

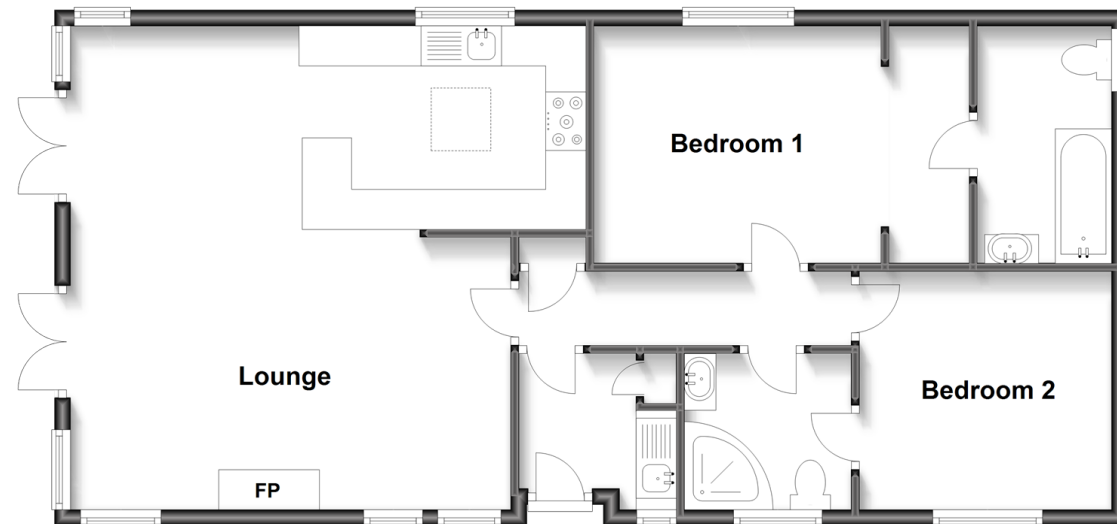

Call Headcorn - 01622 890435 ■ wardsof Kent.co.uk

■ If buying to let, the energy rating will need to be improved to at least 'E' rating before you can let the property

■ Appliances & services are untested, dimensions are approximate and floor plans are not to scale

■ Legal advice should be taken to verify fixtures/fittings, planning, alterations and/or lease details



14006752/20240124/HS1/TB