



OVER 60?

You could get up to
59% off the price!*



Video Tour available

Price

£300,000

Freehold

3x  1x  2x 

**Brickwall Terrace,
Susans Hill,
Woodchurch, Ashford,
Kent, TN26**

Wards
Helping you move forwards



Main features

- 3 bedroom mid-terrace house set over 3 floors
- Gardens both front and rear
- Versatile layout
- Popular safe and friendly village location
- Stunning rural countryside views

Accommodation

GROUND FLOOR

Lounge: 12'0 x 11'0 (3.66m x 3.36m)

Kitchen/Diner: 14'0 x 10'11 (4.27m x 3.33m)

FIRST FLOOR

Bedroom 1: 12'6 x 11'0 (3.81m x 3.36m)

Bathroom: 6'6 x 5'10 (1.98m x 1.78m)

Bedroom 3: 10'3 x 6'9 (3.13m x 2.06m)

SECOND FLOOR

Bedroom 2: 10'3 x 9'0 (3.13m x 2.75m)

Bedroom 4: 10'6 x 6'10 (3.20m x 2.08m)

OUTSIDE

Front & Rear Gardens

Call Tenterden - 01580 766002 ■ wardsofkent.co.uk

- Legal advice should be taken to verify fixtures/fittings, planning, alterations and/or lease details
- Appliances & services are untested, dimensions are approximate and floor plans are not to scale
- Our Homewise partnership offer a 'Home for Life' plan to buyers over 60, granting a lifetime lease for your protection and reducing the purchase price by up to 59%

Ground Floor
Approx. 28.5 sq. metres (306.7 sq. feet)

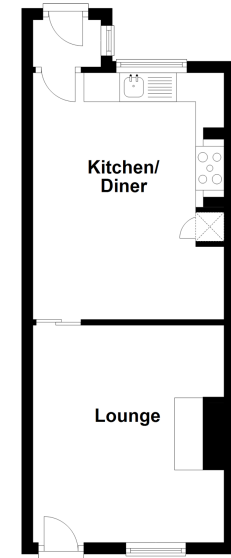

First Floor
Approx. 27.4 sq. metres (295.0 sq. feet)

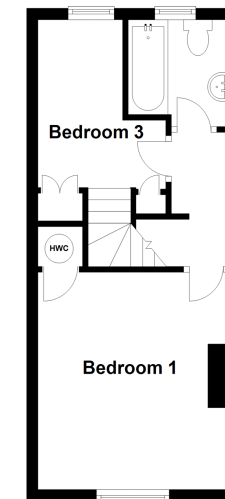

Second Floor
Approx. 18.0 sq. metres (193.8 sq. feet)

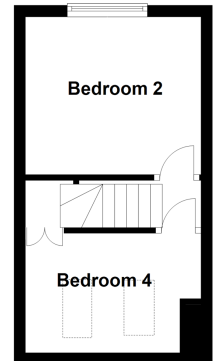

14007159/20220129/AQ/AQ