



Price
£325,000

Freehold

2x  1x  1x 

**Mansion House Close,
Biddenden, Ashford,
Kent, TN27**

OVER 60?

Secure this property
for up to **59% less!**



Video Tour available

Wards
Helping you move forwards



Main features

- Beautiful semi-detached 2 bedroom house
- Attractive low maintenance rear garden
- Modern well designed kitchen with views of the garden
- Garage and off road parking
- Highly desirable village location

Accommodation

GROUND FLOOR

Hall

Kitchen: 12'0 x 8'1 (3.66m x 2.47m)

Lounge/Diner: 15'5 x 12'1 (4.70m x 3.69m)

FIRST FLOOR

Landing

Bathroom: 6'2 x 5'6 (1.88m x 1.68m)

Bedroom 1: 11'5 x 9'10 (3.48m x 3.00m)

Bedroom 2: 9'9 x 6'3 (2.97m x 1.91m)

OUTSIDE

Front and Rear Gardens

Garage and Driveway

Ground Floor

Approx. 26.7 sq. metres (287.5 sq. feet)

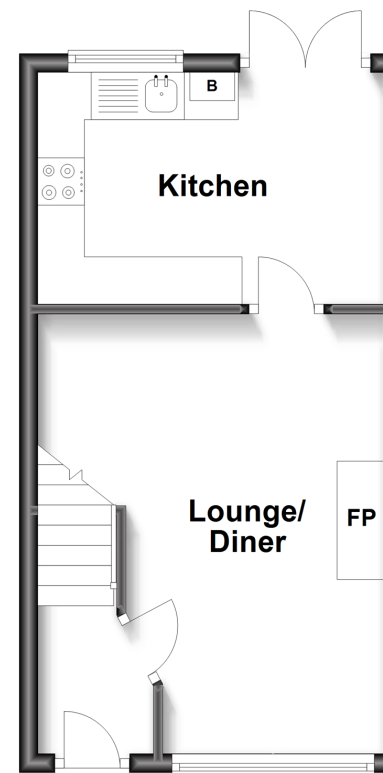

First Floor

Approx. 26.7 sq. metres (287.5 sq. feet)

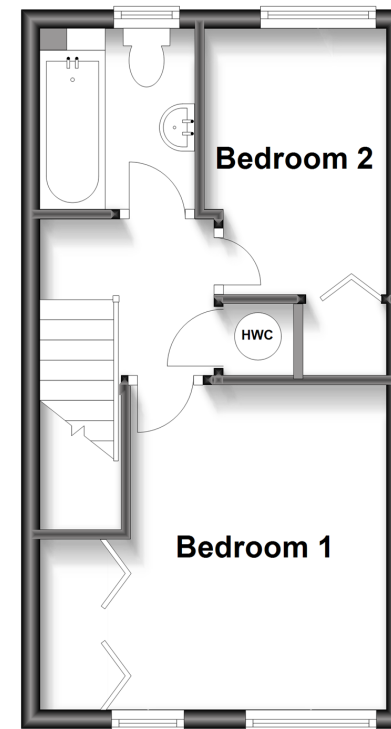

Call Tenterden - 01580 766002 ■ wardsofkent.co.uk

- Legal advice should be taken to verify fixtures/fittings, planning, alterations and/or lease details
- Appliances & services are untested, dimensions are approximate and floor plans are not to scale
- Through a Homewise Home For Life Plan people aged 60+ can secure this property for up to 59% less, by purchasing a Lifetime Lease.



14007283/20230209/AQ/AQ