



OVER 60?

Secure this property
for up to **59% less!**

Price

£425,000

Freehold

3x  1x  1x 

**Cherwell Close,
Tonbridge, Kent, TN10**

Wards
Helping you move forwards



Main features

- No Onward Chain
- Spacious driveway
- Recently update through out
- Great location with amenities near by
- Open plan living dining space backing onto private garden

Accommodation

GROUND FLOOR

Porch

Lounge: 14'9 x 14'8 (4.50m x 4.47m)

Dining Area: 9'8 x 7'8 (2.95m x 2.34m)

Kitchen: 9'11 x 6'10 (3.02m x 2.08m)

FIRST FLOOR

Landing

Bedroom 1: 16'5 x 8'5 (5.01m x 2.57m)

Bedroom 2: 9'2 x 6'6 (2.80m x 1.98m)

Bedroom 3: 10'9 x 6'2 (3.28m x 1.88m)

Bathroom

OUTSIDE

Driveway

Front & Rear Gardens

Ground Floor

Approx. 36.8 sq. metres (396.6 sq. feet)

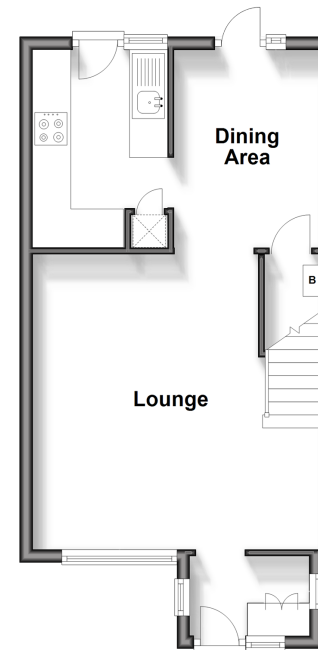

First Floor

Approx. 34.4 sq. metres (370.2 sq. feet)

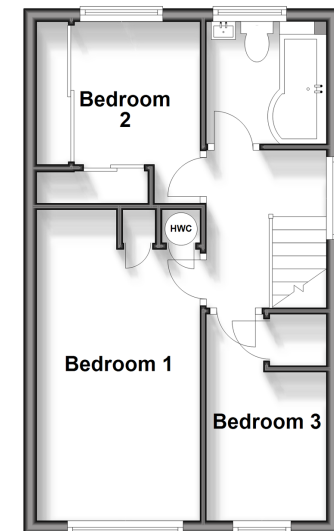

Call Tonbridge - 01732 770755 ■ wardsofkent.co.uk

■ Legal advice should be taken to verify fixtures/fittings, planning, alterations and/or lease details
 ■ Through a Homewise Home For Life Plan people aged 60+ can secure this property for up to 59% less, by purchasing a Lifetime Lease.

■ Appliances & services are untested, dimensions are approximate and floor plans are not to scale