



**OVER 60?**

Secure this property  
for up to **59% less!**

**Price**

**£375,000**

**Freehold**

2x  1x  1x 

**Luckhurst Gardens,  
Cliftonville, Margate,  
Kent, CT9**

*Wards*  
Helping you move forwards





## Main features

- Situated in a quiet location
- Walking distance to schools, local shops and sandy beaches
- Log burner to keep warm in the winter months
- Conservatory looking out to sunny garden
- Versatile garden log cabin with power & heating

## Accommodation

### GROUND FLOOR

Hallway

Kitchen: 9'10 x 8'9 (3.00m x 2.67m)

Lounge/Diner: 18'3 x 14'3 (5.57m x 4.35m)

Conservatory: 13'2 x 6'10 (4.02m x 2.08m)

Bathroom: 6'11 x 5'9 (2.11m x 1.75m)

Bedroom 1: 11'10 x 9'4 (3.61m x 2.85m)

Bedroom 2: 8'11 x 8'9 (2.72m x 2.67m)

### OUTSIDE

Front Garden

Garage

Off Road Parking

Log cabin: 19'1 x 7'2 (5.82m x 2.19m)

Rear Garden

### Ground Floor

Approx. 75.0 sq. metres (807.2 sq. feet)

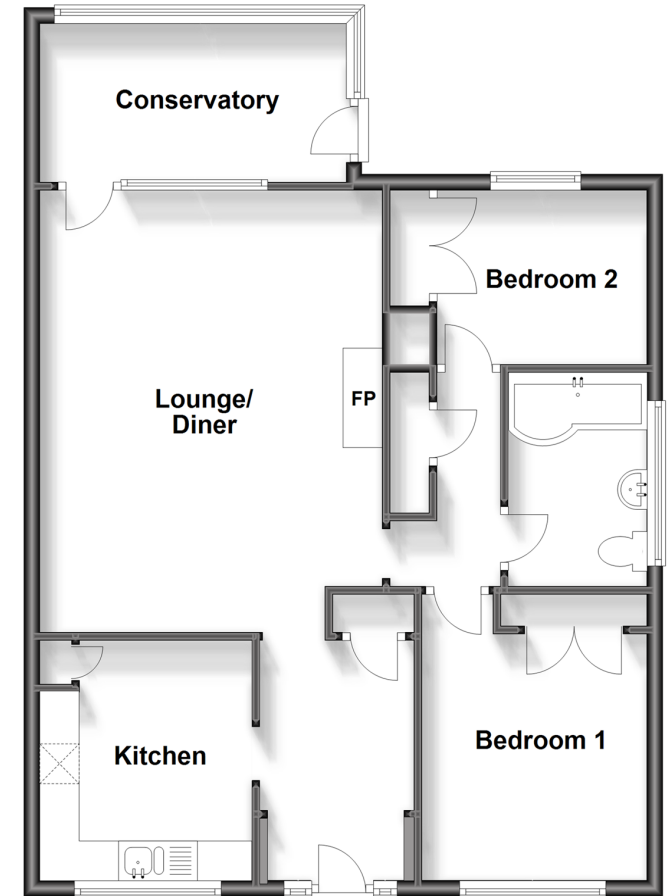

**Call Cliftonville - 01843 227447 ■ [wardsofkent.co.uk](http://wardsofkent.co.uk)**

- A private rental licensing scheme applies to some properties in this area, please contact us before proceeding
- Legal advice should be taken to verify fixtures/fittings, planning, alterations and/or lease details
- Appliances & services are untested, dimensions are approximate and floor plans are not to scale
- Through a Homewise Home For Life Plan people aged 60+ can secure this property for up to 59% less, by purchasing a Lifetime Lease.

